



HEARTWOOD
HOMES

Caledon Road, London Colney, St. Albans, AL2 1PR

Guide Price £450,000

3 1 2



A larger than average three bedroom terraced family home which is set in a popular road within the village of London Colney, close to a fantastic selection of local shopping facilities, sought after schools and the motorway networks. Entrance hall | Two reception rooms | Three generous bedrooms





GROUND FLOOR
467 sq.ft. (43.4 sq.m.) approx.

1ST FLOOR
483 sq.ft. (45.0 sq.m.) approx.

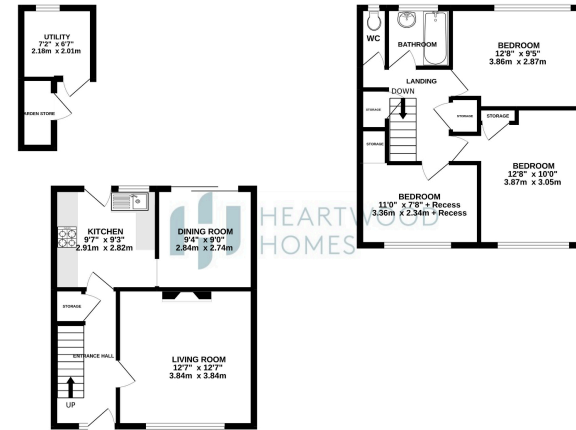

TOTAL FLOOR AREA: 950 sq.ft. (88.4 sq.m.) approx.
HEARTWOOD HOMES has been made to ensure the accuracy of the floorplan information. Measurements of rooms, windows, doors and any other items are approximate and not necessarily to scale for any one particular room. The floorplan is for information only and should not be used as a basis for any prospective purchase. The correct, complete and accurate details must be based on and no guarantee. Map ref: 10022

